

# 934-425

Lv7 2021-r2

Modelo-model:

## Kit soportes LCV

Lote-Lot-Lot-Lot:

**01-19**

Peso-Weight-Poids-Gewicht:

**2,91 kg**

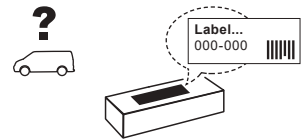

**Max: 150 kg**



CEE - EEC type approval:

**(E9)** 26 R- 04 3022



**CITY CRASH** (M)

CRUZBER SA  
ES-A14018311  
P.I. Las Salinas II  
14960 - Rute - Spain  
[www.cruzber.com](http://www.cruzber.com)

- |   |                         |
|---|-------------------------|
| <b>(E)</b> Instrucción de montaje<br>¡Leer primero!                   | Kit fijación            |
| <b>(GB)</b> <b>Assembly instructions</b><br>Read first!               | Fixation Kit            |
| <b>(F)</b> <b>Instruction de montage</b><br>Lire en premier!          | Kit fixation            |
| <b>(D)</b> <b>Montageanleitung</b><br>Zuerst lesen!                   | Stützfuß-Kit            |
| <b>(PT)</b> <b>Instruções de montagem</b><br>Ler primeiro!            | Kit fixação             |
| <b>(PL)</b> <b>Instrukcja montażu</b><br>Najpierw przeczytaj!         | Element mocujący        |
| <b>(CZ)</b> <b>Montážní návod</b><br>Čtěte pozorně!                   | Fixační kit             |
| <b>(HU)</b> <b>Szerelési Utasítás</b><br>Először olvassd el!          | Rögzítő készlet         |
| <b>(RO)</b> <b>Instructiuni de montaj</b><br>Intai cititi!            | Kit de fixare           |
| <b>(HR)</b> <b>Detaljne upute</b><br>Prvo pročitati!                  | Kit za montažu          |
| <b>(GR)</b> <b>Διαβάστε προσεκτικά τις</b><br>Οδηγίες Συναρμολόγησης! | Κιβώτιο (Kit) Επισκευής |
| <b>(TR)</b> <b>Öncelikle montaj:</b><br>Talimatlarını okuyunuz!       | Montaj kiti             |
| <b>(RU)</b> <b>Инструкции по монтажу</b><br>Сначала прочитайте!       | Крепежный комплект      |
| <b>(I)</b> <b>Istruzioni di montaggio</b><br>Leggere per primo!       | Kit di fissaggio        |
| <b>(NL)</b> <b>Montagehandleiding</b><br>Eerst lezen!                 | Bevestigingsset         |
| <b>(SLO)</b> <b>Navodila za sestavljanje</b><br>Preberite!            | Kit za pričvrstitev     |



1.

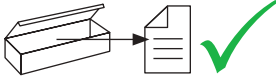

(E) Contenido embalaje: ¡Verificar!

(GB) Package content: Check!

(F) Contenu d'emballage: Vérifier!

(D) Packungsinhalt: Überprüfen!

(PT) Contéudo embalagem:  
Verificar!

(PL) Zawartość opakowania:  
sprawdź!

(CZ) Obsah balení: Zkontrolujte!

(HU) Csomag tartalma: Ellenőrizd!

(RO) Pachetul contine: Verificati!

(HR) Sadržaj paketa: Provjeri!

(GR) Ελέγξτε το περιεχόμενο του  
πακέτου!

(TR) Paket içeriğini: Control ediniz!

(RU) Содержание упаковки:  
Проверьте!

(I) Contenuto della confezione:  
Controllare!

(NL) Pakket inhoud: Controleer!

(SLO) Vsebina paketa: Preverite!

x1



x6

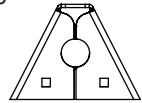

(500)

x6



(854)

x3



1x (805-014)

1x (810-040)

1x (810-181)

x6



(813-073)

2. 

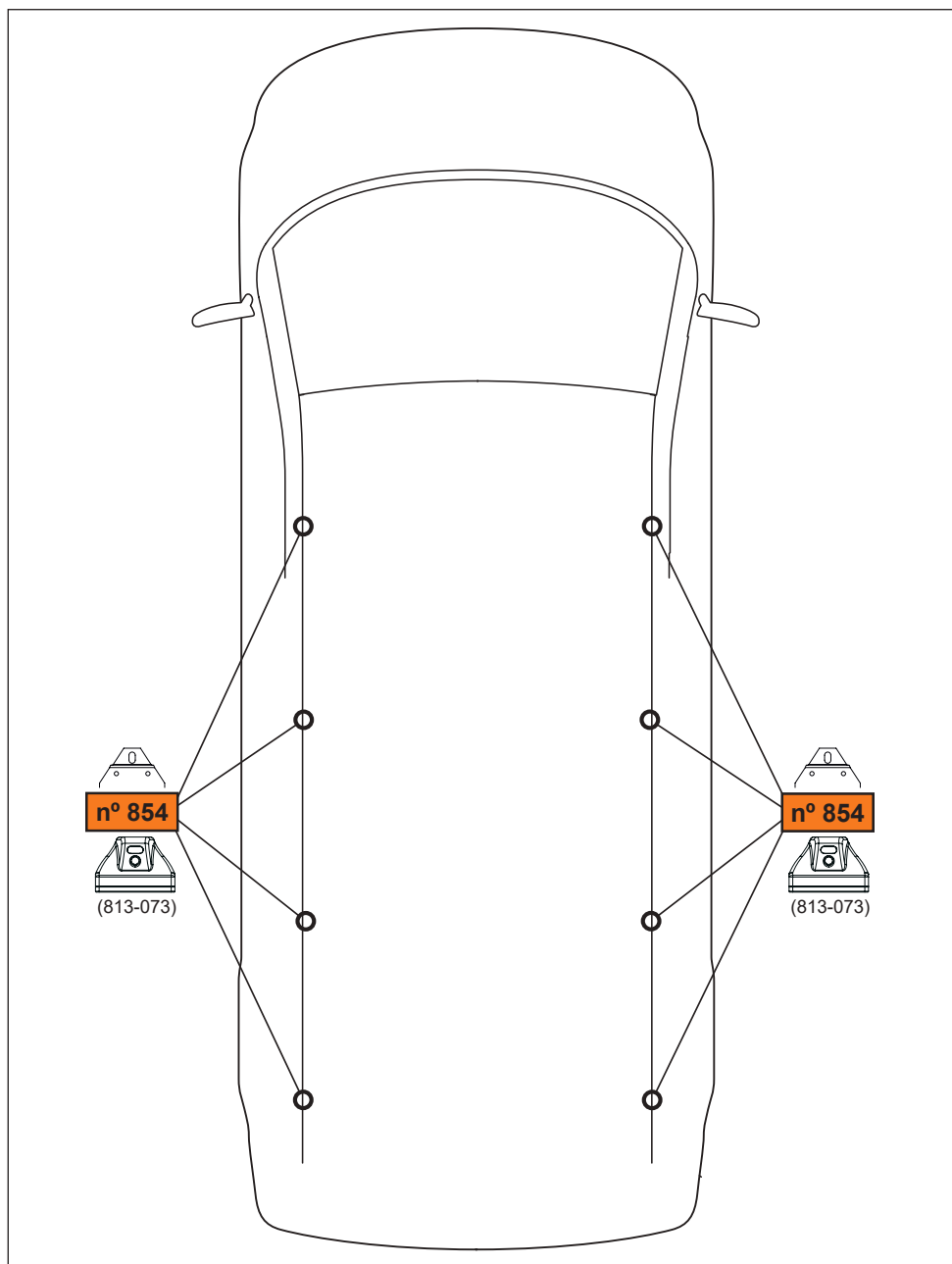

3. 

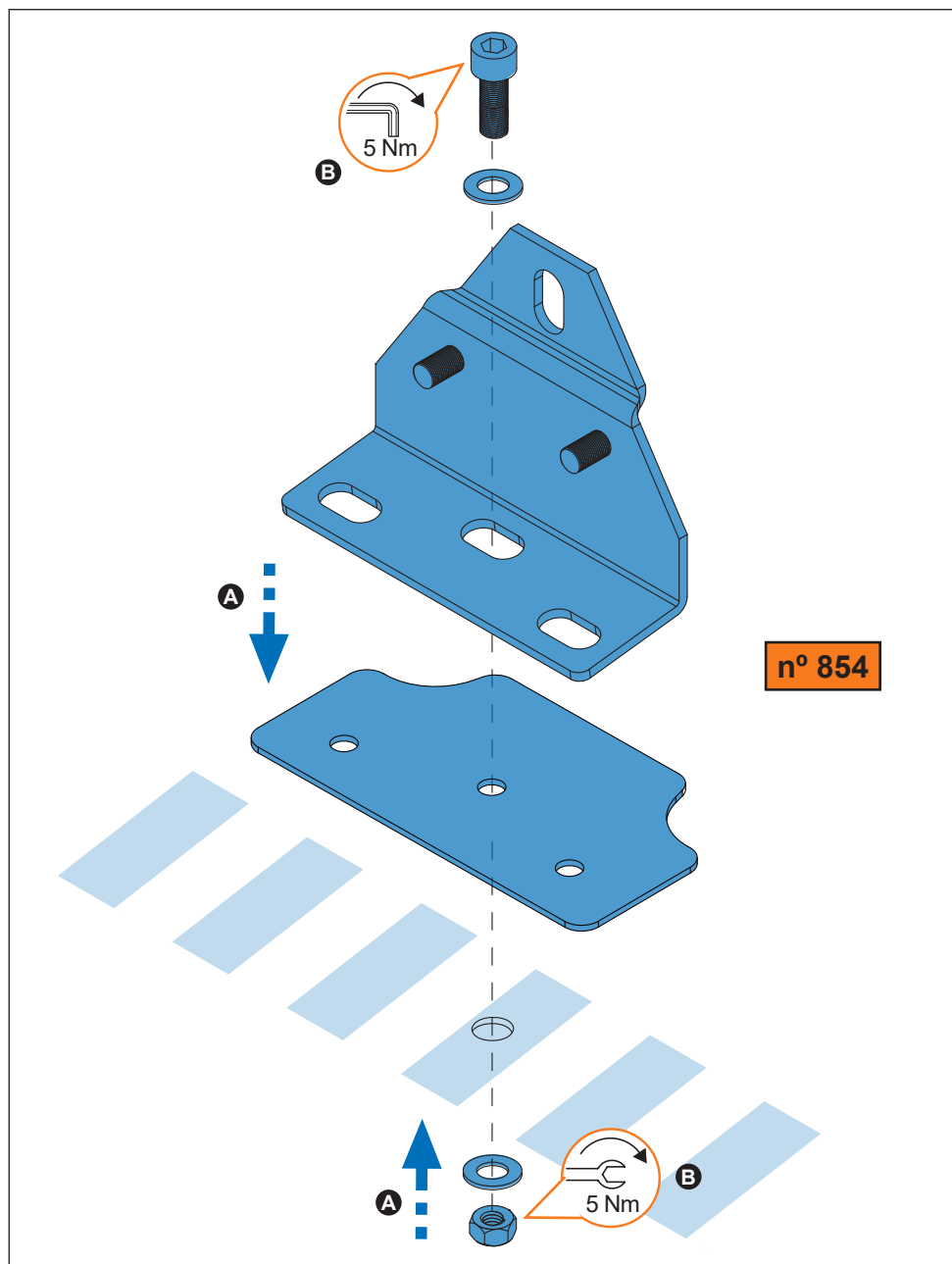

4. 

**Opcional:**  
Carril de techo

**Optional:**  
T-Track

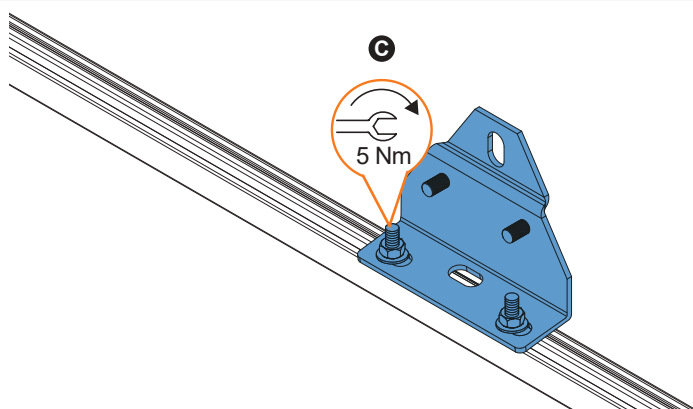
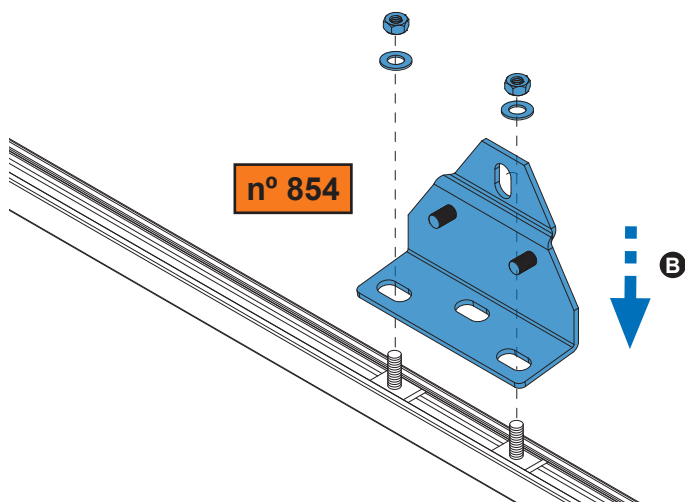
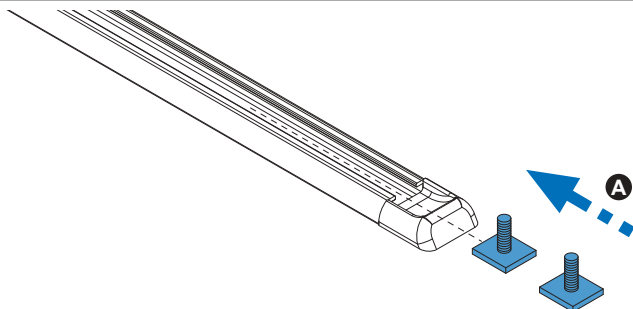
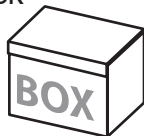

5. 

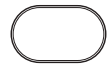

50x30 mm

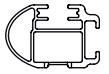

52x35 mm  
Aluminium

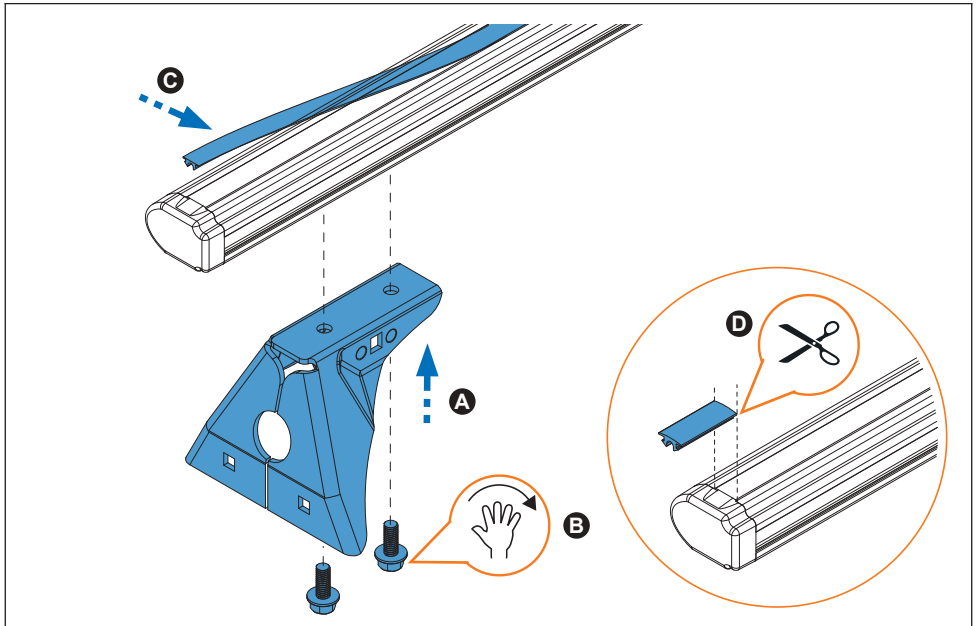
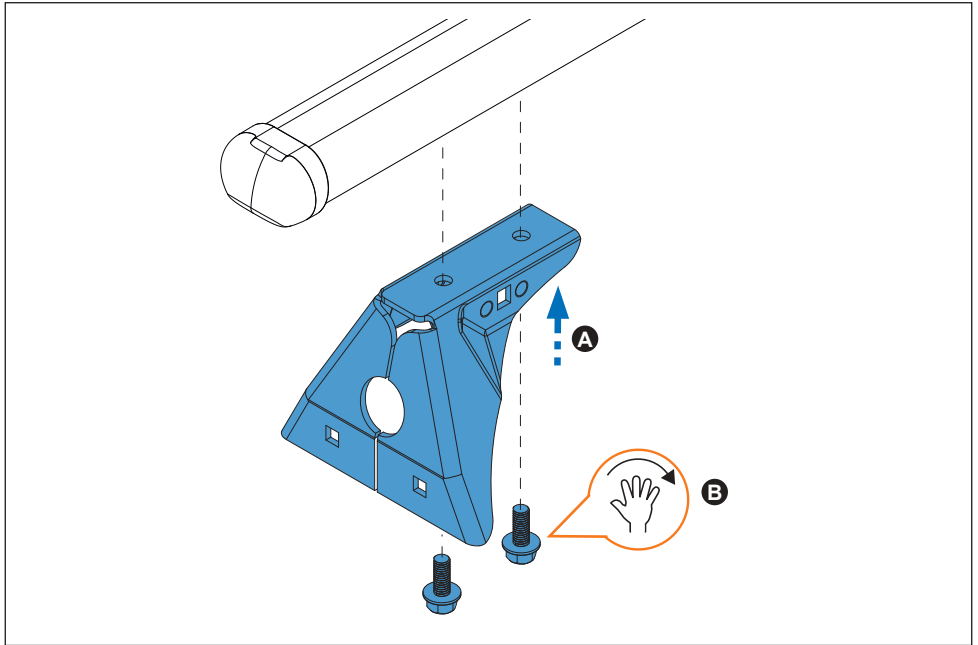

6. 

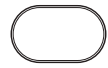

50x30 mm

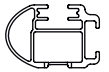

52x35 mm  
Aluminium

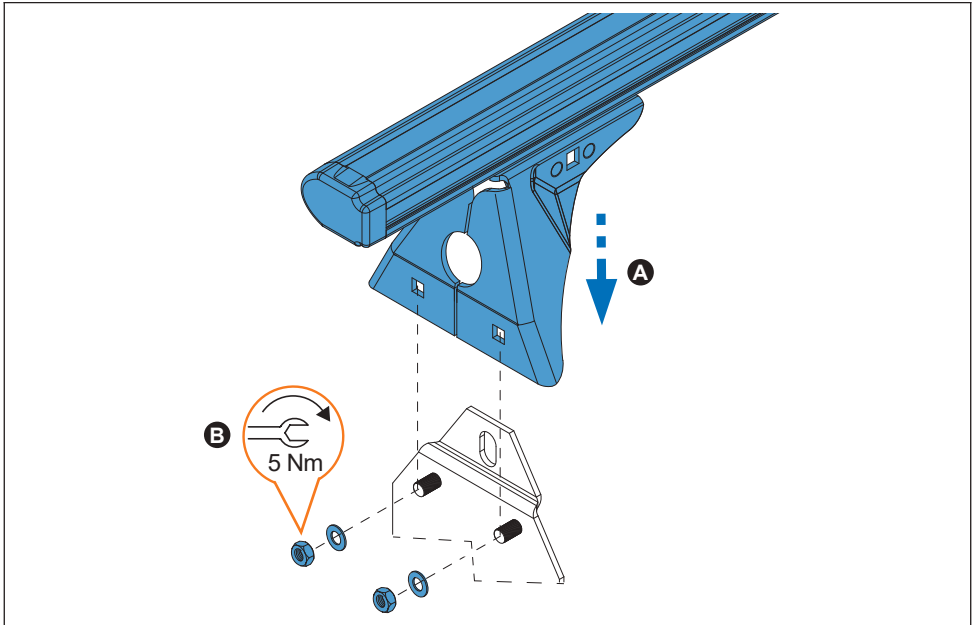
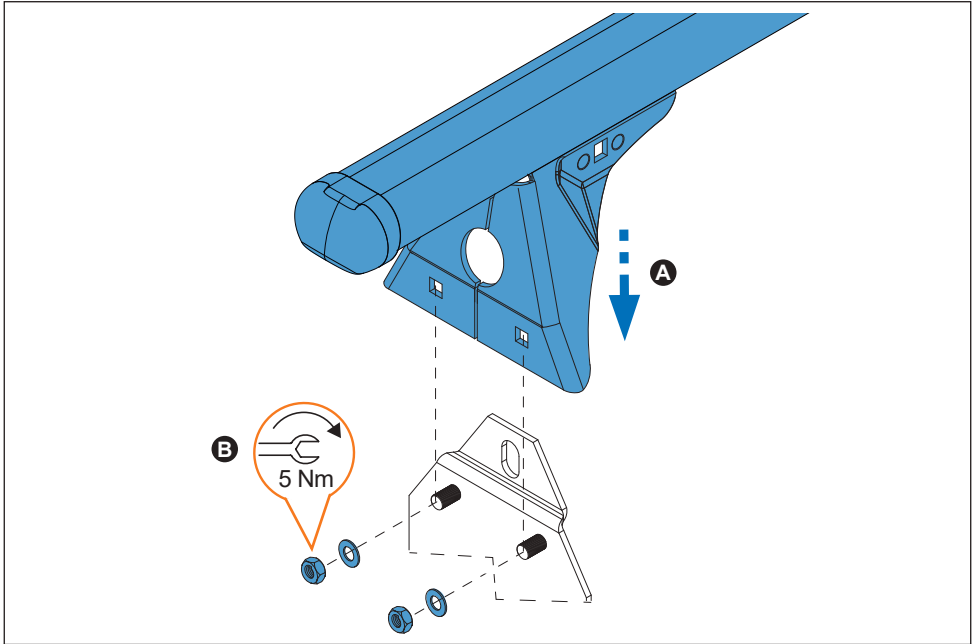

7. 

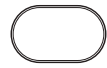

50x30 mm

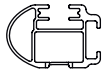

52x35 mm  
Aluminium

